



6390 Philips Highway  
Jacksonville, FL 32216  
Phone (904) 737-7144

## SPECIFICATION DATA SHEET

# MODEL No. 920

### SUPPLY CONNECTOR

Date: 3/16/05

Drawn by: Don.Jr.

#### DIMENSIONAL DATA

INLET COLLAR DIAMETER:

8"  
9"  
10"  
12"  
14"

#### FABRICATION DATA

MATERIAL:  
FABRICATED FROM HOT DIPPED GALVANIZED  
STEEL SHEETS OF LOCK FORMING QUALITY  
PER ASTM-A653 CS TYPE B.

GAUGES:  
ALL SIZES = 28 GAUGE

#### FEATURES

POCKET OF RING SEAL COLLAR MAINTAINS  
FULL 1-1/2" INSULATION THICKNESS.

LOOSE-PIN HINGED BUTTERFLY TYPE  
ALUMINUM DAMPER INSTALLED.

GASKET MATERIAL SEALS TRUNK DUCT  
PENETRATION.

3/4" DOVETAILS FOR SECURING COLLAR TO  
TRUNK DUCT.

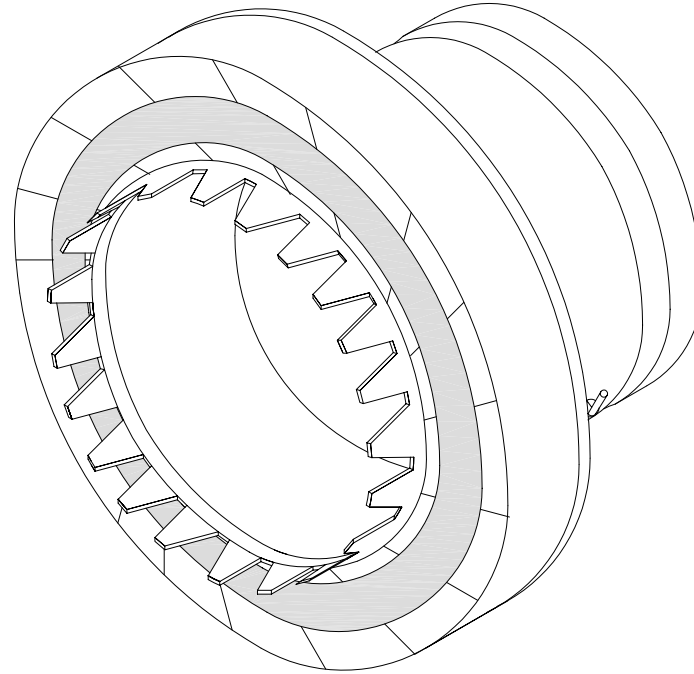

#### OPTIONS

#### SPECIAL NOTES